

RE 16 Ø16 mm, Graphite Brushes, 4.5 Watt

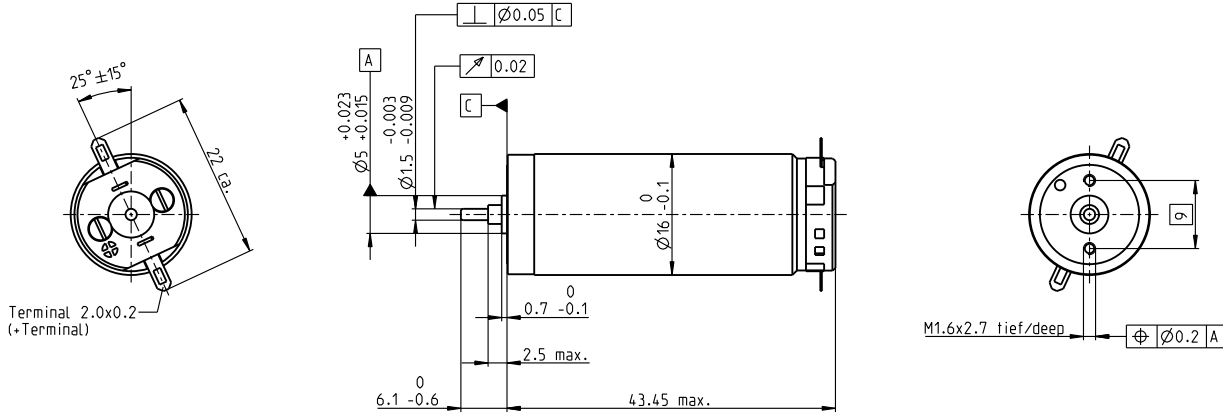

M 1:1

- Stock program
- Standard program
- Special program (on request)

Part Numbers

118710	118711	118712	118713	118714	118715	118716	118717	118718	118719	118720	118721	118722	118723	118724
--------	--------	--------	--------	--------	--------	--------	--------	--------	--------	--------	--------	--------	--------	--------

Motor Data		118710	118711	118712	118713	118714	118715	118716	118717	118718	118719	118720	118721	118722	118723	118724
Values at nominal voltage																
1 Nominal voltage	V	4.8	4.8	6	7.2	9	12	15	18	24	30	36	45	48	48	48
2 No load speed	rpm	12700	12100	13200	13600	13100	13900	14000	13200	14000	14700	14100	14500	14200	10100	5320
3 No load current	mA	105	98.7	87.6	75.4	56.9	45.9	37.1	28.5	23	19.6	15.6	12.8	11.8	7.66	3.63
4 Nominal speed	rpm	11200	10500	11500	11700	11000	11900	12100	11300	12100	12900	12300	12700	12400	8120	3170
5 Nominal torque (max. continuous torque)	mNm	2.15	2.27	2.67	3.18	4.23	4.36	4.42	4.53	4.53	4.4	4.46	4.42	4.43	4.65	4.77
6 Nominal current (max. continuous current)	A	0.72	0.72	0.72	0.72	0.712	0.582	0.475	0.379	0.302	0.247	0.2	0.163	0.15	0.111	0.0603
7 Stall torque	mNm	26.3	22.8	25.8	27.4	29.9	34.3	35.3	33.4	36.3	36.8	35.6	36.2	35.4	24.2	12.1
8 Stall current	A	7.56	6.26	6.16	5.58	4.65	4.23	3.51	2.6	2.24	1.91	1.48	1.23	1.11	0.541	0.144
9 Max. efficiency	%	73	72	74	76	77	79	80	80	80	81	81	81	81	78	71
Characteristics																
10 Terminal resistance	Ω	0.635	0.767	0.975	1.29	1.94	2.83	4.28	6.93	10.7	15.7	24.4	36.5	43.3	88.7	334
11 Terminal inductance	mH	0.021	0.023	0.03	0.042	0.071	0.113	0.174	0.284	0.452	0.639	0.993	1.48	1.74	3.44	12.1
12 Torque constant	mNm/A	3.48	3.64	4.2	4.91	6.43	8.11	10.1	12.9	16.2	19.3	24.1	29.4	31.9	44.8	83.9
13 Speed constant	rpm/V	2750	2630	2280	1940	1480	1180	948	742	589	495	397	325	299	213	114
14 Speed / torque gradient	rpm/mNm	502	554	529	510	447	411	403	399	389	403	402	404	407	423	453
15 Mechanical time constant	ms	9.07	8.35	7.36	6.71	6.13	5.78	5.56	5.43	5.31	5.28	5.25	5.23	5.22	5.24	5.28
16 Rotor inertia	gcm ²	1.73	1.44	1.33	1.26	1.31	1.34	1.32	1.3	1.3	1.25	1.25	1.24	1.23	1.18	1.11

Specifications

- Thermal data**
- 17 Thermal resistance housing-ambient 30 K/W
 - 18 Thermal resistance winding-housing 8.5 K/W
 - 19 Thermal time constant winding 10.6 s
 - 20 Thermal time constant motor 504 s
 - 21 Ambient temperature -20...+65°C
 - 22 Max. winding temperature +85°C
- Mechanical data (sleeve bearings)**
- 23 Max. speed 16000 rpm
 - 24 Axial play 0.05 - 0.15 mm
 - 25 Radial play 0.014 mm
 - 26 Max. axial load (dynamic) 0.8 N
 - 27 Max. force for press fits (static) 15 N
 - 28 Max. radial load, 5 mm from flange 1.5 N
- Other specifications**
- 29 Number of pole pairs 1
 - 30 Number of commutator segments 7
 - 31 Weight of motor 40 g

Values listed in the table are nominal.
Explanation of the figures on page 151.

Operating Range

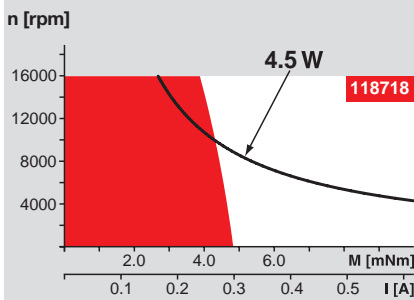

Comments

- Continuous operation**
In observation of above listed thermal resistance (lines 17 and 18) the maximum permissible winding temperature will be reached during continuous operation at 25°C ambient.
= Thermal limit.
- Short term operation**
The motor may be briefly overloaded (recurring).
- Assigned power rating**

maxon Modular System

Overview on page 20-27

- Planetary Gearhead**
Ø16 mm
0.1 - 0.3 Nm
Page 323
- Planetary Gearhead**
Ø16 mm
0.2 - 0.6 Nm
Page 324
- Spindle Drive**
Ø16 mm
Page 365-367

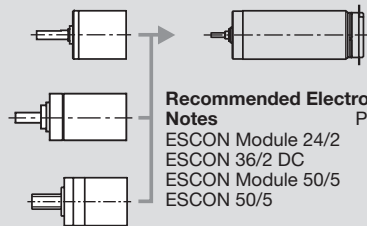

- Recommended Electronics:**
Notes Page 24
- ESCON Module 24/2 416
 - ESCON 36/2 DC 416
 - ESCON Module 50/5 417
 - ESCON 50/5 418